



Cabinet Systems

How to guide - Corner Void Cabinet

Select your product

1. Navigate to the "Add Product" tab

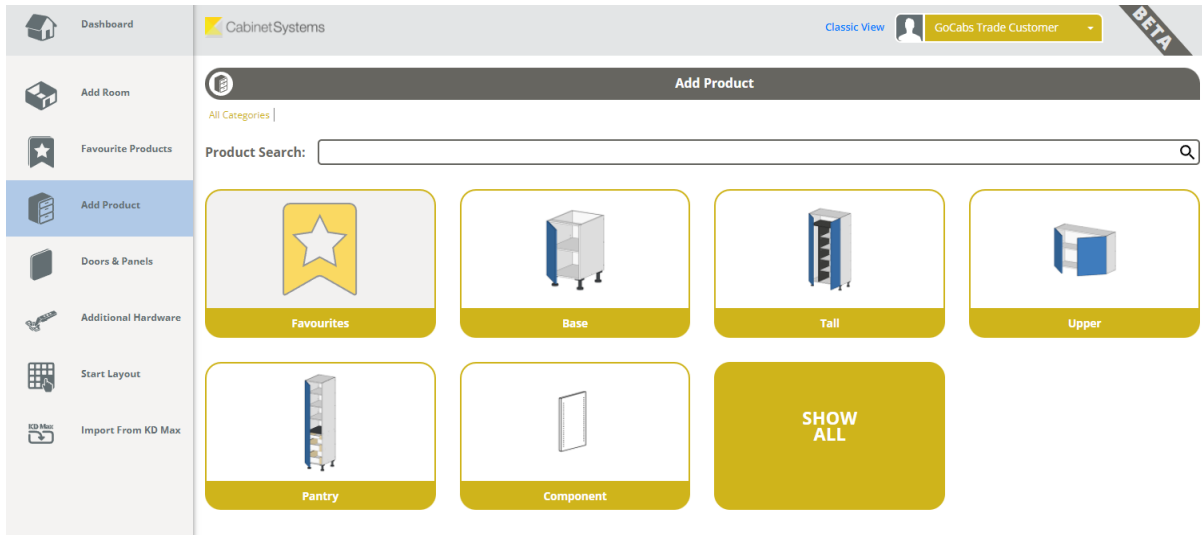

2. Select "Base" - "Corner L Shape" - "Corner Void"

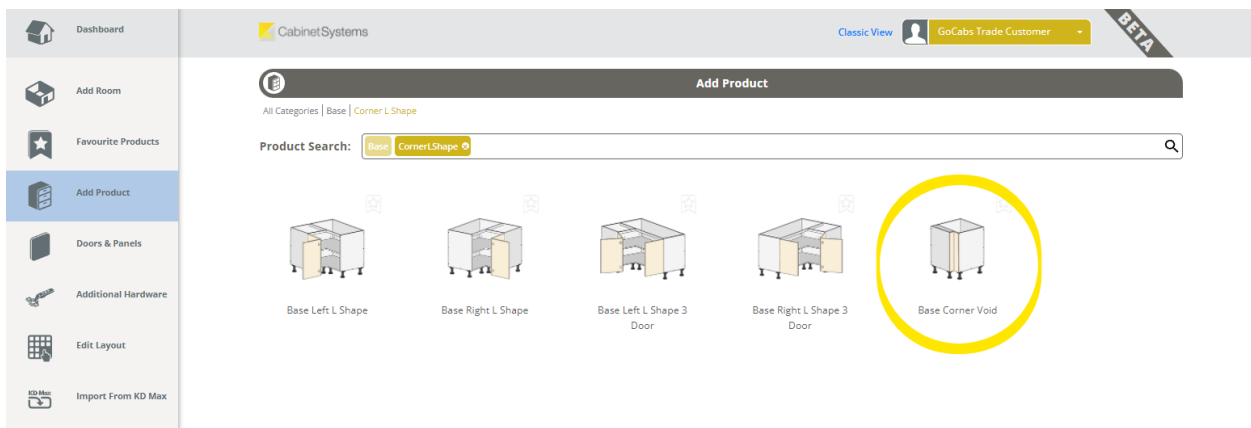



Cabinet Systems

Edit the sizes tab

1. Set your sizing - refer to the top down view as a visual guide

All Categories | Base | Corner L Shape | Base Corner Void

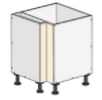

Base Corner Void

Sizes	Materials	Doors
Quantity : *	<input type="text" value="1"/>	
Height : *	<input type="text" value="720"/> mm	
Left Width : *	<input type="text" value="1000"/> mm	
Right Width : *	<input type="text" value="1000"/> mm	
Left Depth : *	<input type="text" value="560"/> mm	
Right Depth : *	<input type="text" value="560"/> mm	
Top : *	<input type="text" value="Ls Solid Top"/>	
Product Supply Methods :	<input type="text" value="Flat Pack"/>	
Supply Hardware Methods :	<input type="text" value="Drill Panels Only"/>	

Individual componentry packed flat and loaded onto a pallet or similar which is wrapped in plastic film.

Supply of cut, edged and drilled panels only. Not inclusive of any cabinet hardware or screws.

[Notes & Variations \(Click for more\)](#)

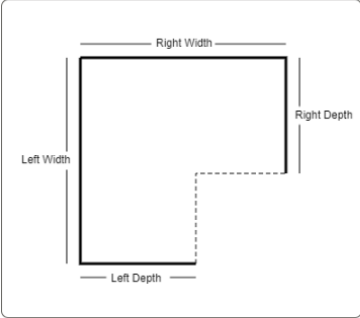

2. Flow through the familiar tabs **“Materials”** - **“Doors”** to make your further edits

FAQ

Will I be able to access my laminate benchtop toggle bolts?

Yes, by selecting a rail on flat or edge and removing an adjacent cabinet before final installation, you will be able to easily reach through the cut-out side to reach the benchtop from below.

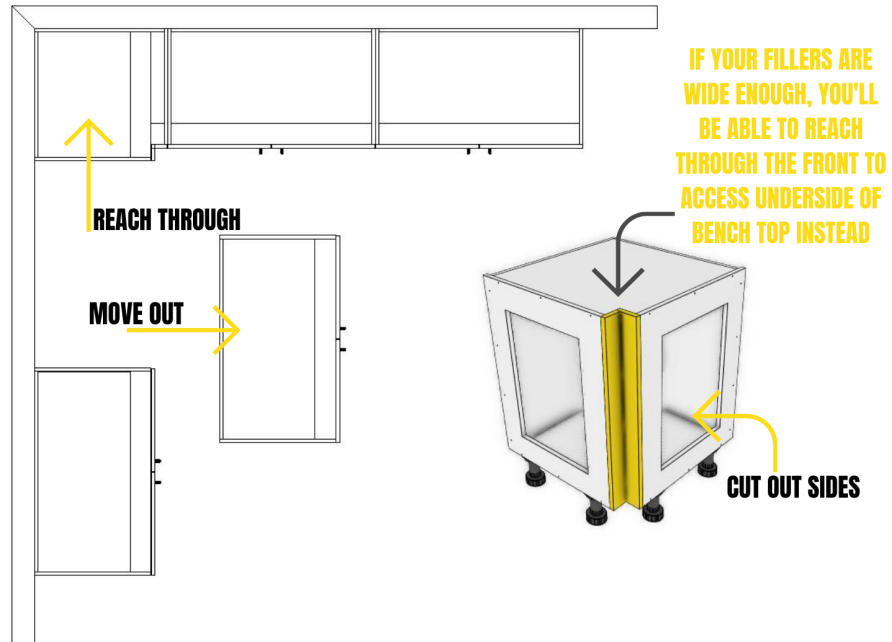



Cabinet Systems

What is the best way to fit my fillers on?

This cabinet uses Hafele 'Keku push in fittings' - The entire assembly will come pre-drilled - assemble your cabinet, attach the fittings to the parts and your fillers will clip on to the cabinet - easily removable if required



Other Features

- Provides a supportive surface for solid surface benchtops
- Aids with accuracy of cabinet placement